

NEW TM10 LED TAIL LIGHT WITH BUILT-IN SIMAC AND INDICATORS FAILURE CONTROL

ERMAX®

The new TM10 LED tail light from Ermax offers unique functions allowing a particularly simple and time-saving installation – NO additional parts or components are needed.

The new TM10 LED tail light has built-in SIMAC (side marker lights flashing simultaneously with the tail flashing lights) and a LED control unit monitoring the indicators function. A complete tail light with the modern facilities mentioned and with an absolutely very wide range of possibilities.

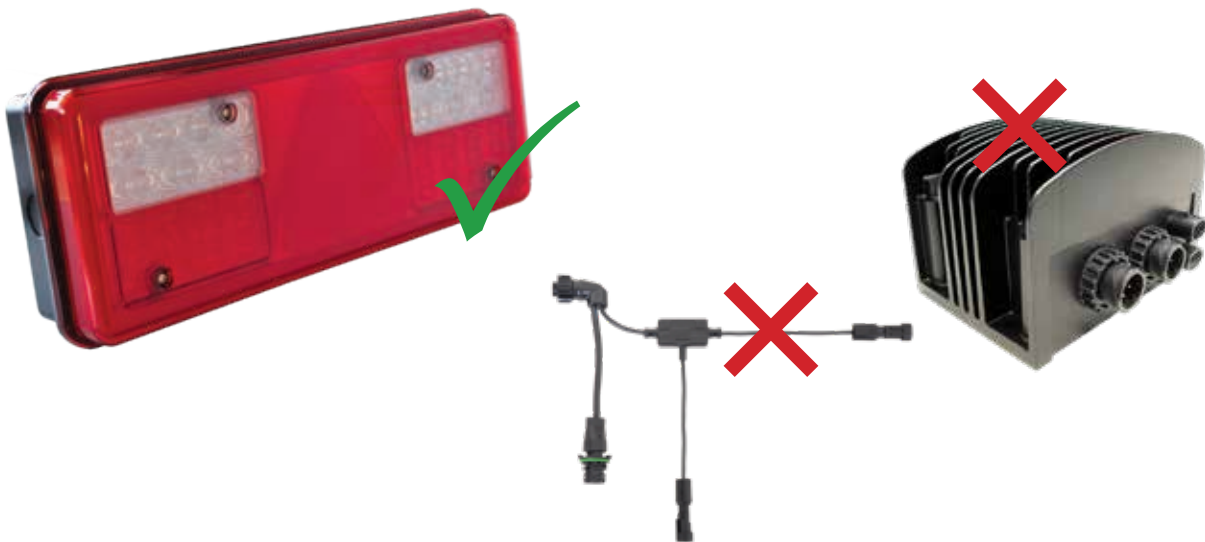

Thanks to the integrated SIMAC function, the side marker lights can be directly and easily connected to the rear side of the TM10 using Super Seal plugs. In addition, the TM10 offers the uncomplicated and additional connection of reversing light, license plate light, outer-end markers and a third stop light on the back of the TM10. Thus the cable system is made very simple and cost efficient.

An example of a cable system with TM10 tail lights with SIMAC and LED Control is shown at page 2.

HIGHLIGHTS

The taillight TM 10 LED with integrated SIMAC function and LED Control offers the following advantages:

- Uncomplicated cable system and fewer plug connections compared to SIMAC “Snap-in” solution
- Several practical connection options in the tail light. In most cases, the junction box can be omitted if this tail light with built-SIMAC function is used
- Integrated LED control for indicators failure control ensures monitoring of indicators functions and installation of separate control unit is no longer required
- One of the strongest lights at the market with impact-resistant glass

ERMAX – “Heavy Duty Made Light”

TECHNICAL INFORMATION

ERMAX[®]

TM10 LED tail light with Simac-function and LED Control use separate outer-end marker lights. We recommend outer-end marker lights (see page 3), which can be mounted directly at the tail light or at a separate fitting and connected through Super Seal plugs at the back side of the TM10 LED tail light.

When license plate light is needed we recommend a variant which also can be connected at the back side of the TM10 LED tail light.

"Sketch"

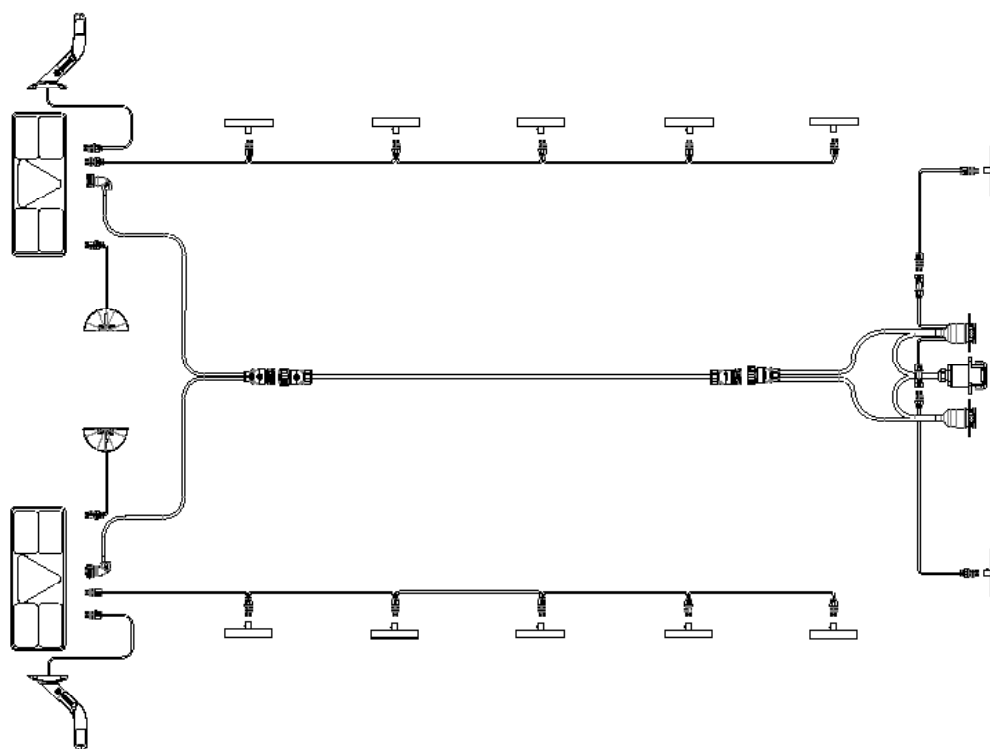

Connection options

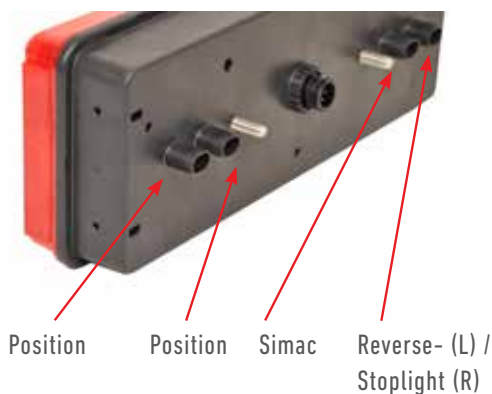

TECHNICAL INFORMATION

ERMAX®

TM10 LED Tail light 24V
with SIMAC and LED Control

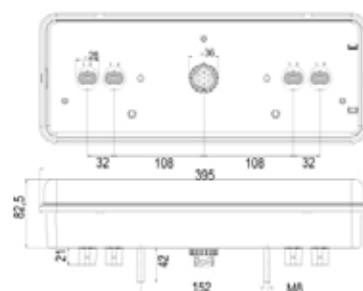

Outer-end marker light has to be mounted and ordered separately - 098 241 438 (R) and 098 241 439 (L)

Functions									
Type	Voltage	IP Rating	Right → Left ←	Position Stop Flasher Rear Fog Sidemarker	Reflector triangle	Connection 7-poled AMP	2x2 Super Seal placed backwards	Article No.	
LED	24V	IP54	→	✓	✓	✓	✓	098 216 524 92.0000.7376	
LED	24V	IP54	←	✓	✓	✓	✓	098 216 525 92.0000.7377	

Outer-end marker light LED (45°)

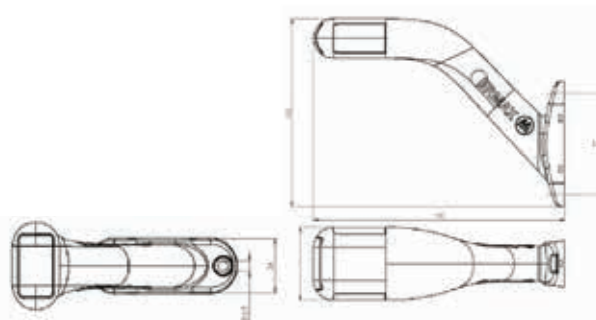

Functions							
Type	Voltage	IP Rating	Right → Left ←	Connection	Cable length	Light colour	Article No.
LED	12/24V	IP67	→	Super Seal plug	300 mm	red / white / orange	098 241 438 92.0000.6355
LED	12/24V	IP67	←	Super Seal plug	300 mm	red / white / orange	098 241 439 92.0000.6356

TECHNICAL INFORMATION



License plate light LED

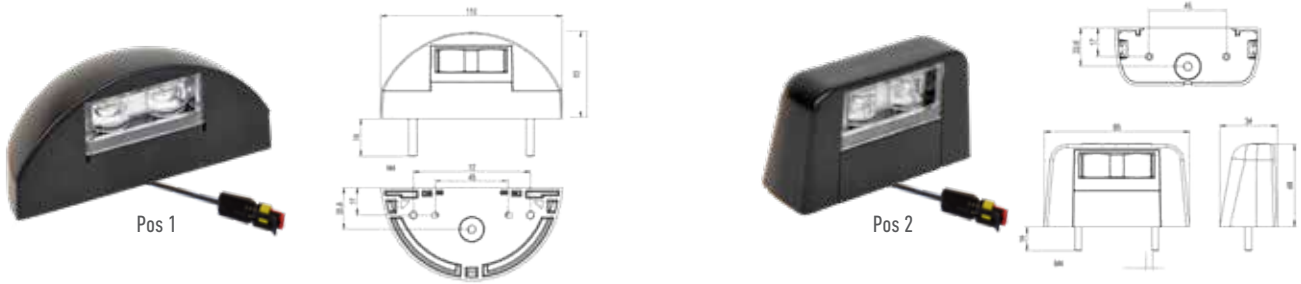

Functions

Type	Voltage	IP Rating	Connection	Cable length	Bolt hole distance	LED number	Pos	Article No.
LED	12/24V	IP69	Super Seal plug	1.200 mm	45 / 72 mm	2	1	098 254 335 92.0000.7168
LED	12/24V	IP69	Super Seal plug	1.200 mm	45 mm	2	2	098 254 345 92.0000.7169